

Aqara

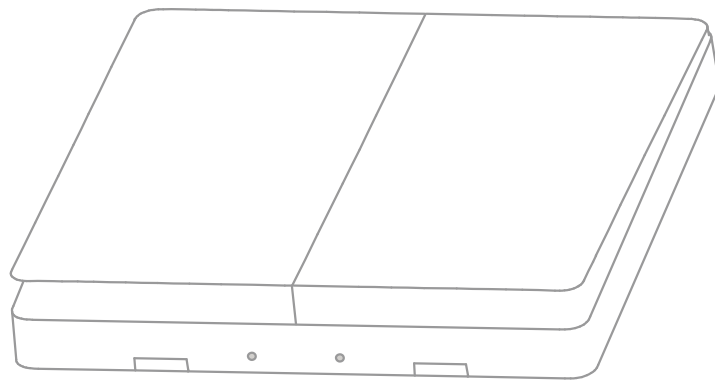

Wireless Remote Switch (Double Rocker)

Wireless Remote Switch (Double Rocker) Quick Start Guide

Product Introduction

Wireless Remote Switch (Double Rocker) is a remote control switch with low energy consumption and standard 86 type industrial design. Simply place or stick it almost anywhere to use. You can control Smart Wall Switch, Smart Plug and other smart accessories with single press, double press or long press of the Wireless Remote Switch.

- * A hub is required.
- * Aqara Hub is required to enable Aqara Wireless Remote Switch (Double Rocker) to work with HomeKit technology. See www.aqara.com for more details.
- * This product is for indoor use only.

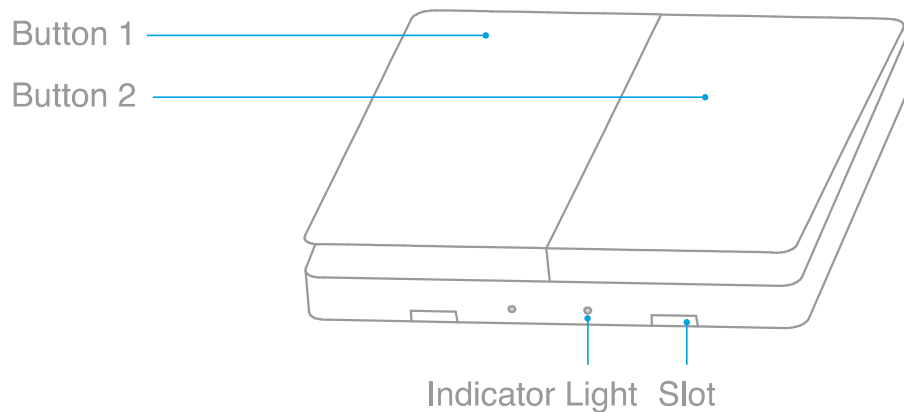

Button
Long Press for 10s: Reset
Quick Press 5 Times: Effective Range Test

Quick Setup

1. Please add the Hub to the app according to the Hub Quick Start Guide.
2. Please open the app, tap “Home” and then tap “+” in the top right corner to enter “Add Device (Accessory)” page. Select “Wireless Remote Switch (Double Rocker)”, and add it according to instructions.

* If the connection fails, please move the accessory closer to the Hub and try again.

Installation

Effective Range Test: Quick press any of the two buttons 5 times at your desired position. If the Hub makes voice prompts, it indicates that the accessory can communicate effectively with the Hub.

* Avoid metal surface to maximize signal strength.

Option 1: Place it directly in the desired position.

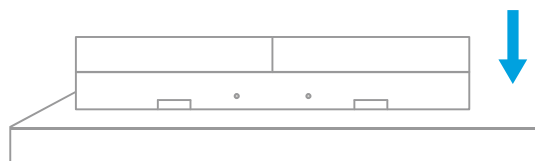

Option 2: Remove the protective film, and stick it to the desired position.

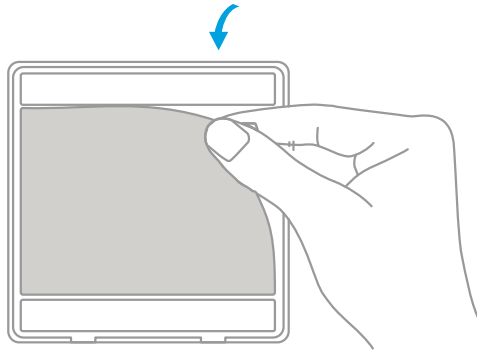

* Keep the surface clean and dry.

Specifications

Model: WXKG02LM

Dimensions: 86 × 86 × 15.12 mm (3.39 × 3.39 × 0.60 in.)

Wireless Protocol: Zigbee

Battery: CR2032

Operating Temperature: -5° – +50° C

Operating Humidity: 5 – 95% RH, no condensation

Online Customer Service: www.aqara.com/support

Email: support@aqara.com

Manufacturer: Lumi United Technology Co., Ltd.

Address: 8th Floor, JinQi Wisdom Valley, No.1 Tangling Road, Liuxian Ave, Taoyuan Residential District, Nanshan District, Shenzhen, China