

Aqara

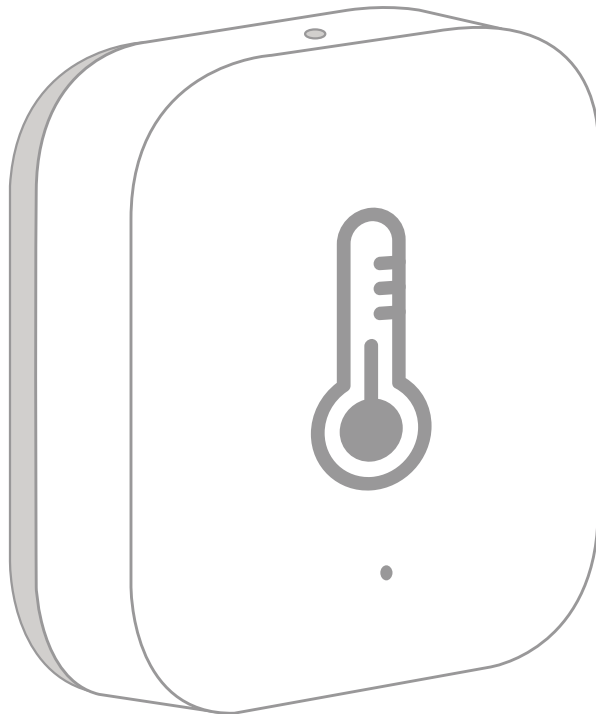

Temperature and Humidity Sensor

Temperature and Humidity Sensor Quick Start Guide

Product Introduction

Aqara Temperature and Humidity Sensor monitors and records indoor temperature, humidity and atmospheric pressure in real time. The current and historical data is displayed in the app. It can also trigger other smart accessories to automate your home.

* A hub is required.

* Aqara Hub is required to enable Aqara Temperature and Humidity Sensor to work with HomeKit technology. See www.aqara.com for more details.

* This product is for indoor use only.

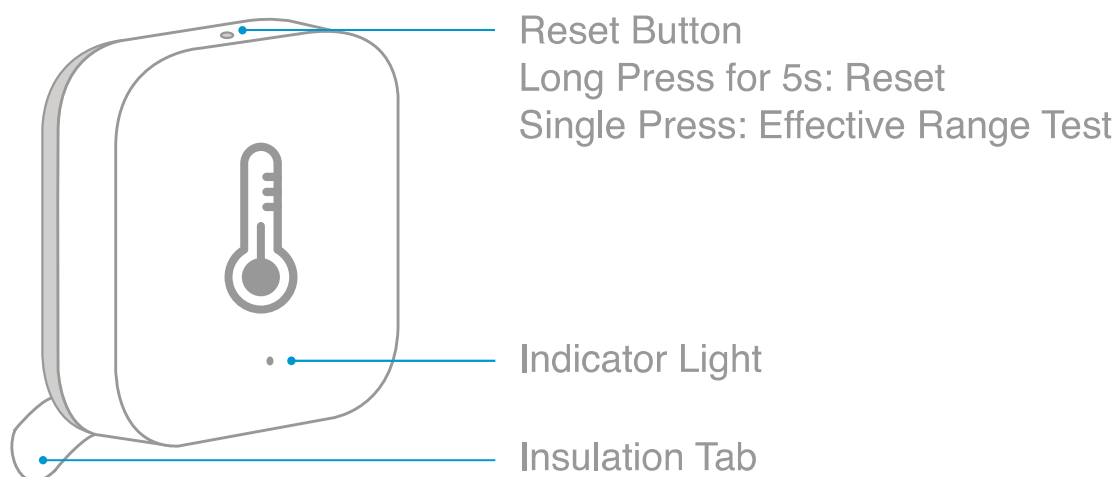

Quick Setup

1. Please add the Hub to the app according to the Hub Quick Start Guide.
2. Please remove the battery insulation tab before use.
3. Please open the app, tap “Home” and then tap “+” in the top right corner to enter “Add Device (Accessory)” page. Select “Temperature and Humidity Sensor”, and add it according to instructions.

* If the connection fails, please move the accessory closer to the Hub and try again.

Installation

Effective Range Test: Single press the reset button on the accessory at your desired position. If the Hub makes voice prompts, it indicates that the accessory can communicate effectively with the Hub.

* Avoid metal surface to maximize signal strength.

Option 1: Place it directly in the desired position.

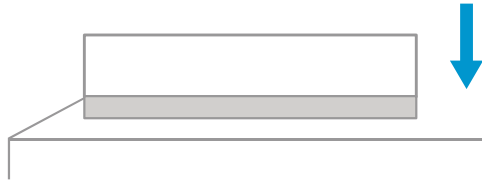

Option 2: Remove the protective film, and stick it to the desired position.

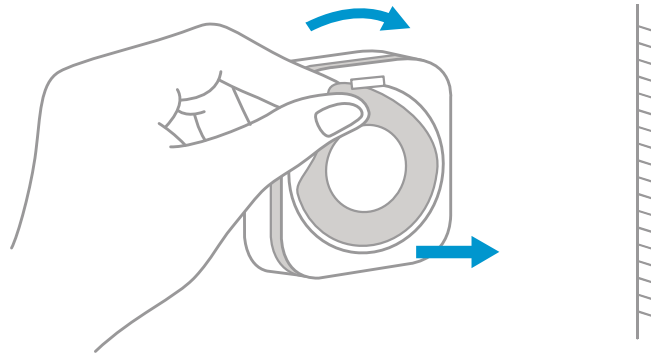

* Keep the surface clean and dry.

Identify an Accessory: Open the app, go to “Device List (Accessories)” page. Single press the reset button on the accessory. If the Hub makes voice prompts and the related accessory icon in the app blinks, it indicates that the accessory is identified.

* Only Aqara Home app and Aqara app support this function.

Specifications

Model: WSDCGQ11LM

Dimensions: 36 × 36 × 9 mm (1.42 × 1.42 × 0.35 in.)

Wireless Protocol: Zigbee

Battery: CR2032

Temperature Range and Precision: -20° – +50° C, ±0.3° C

Humidity Range and Precision: 0 – 100% RH, ±3%

Atmospheric Pressure Range and Precision:

30 kPa – 110 kPa, ±0.12 kPa

Online Customer Service: www.aqara.com/support

Email: support@aqara.com

Manufacturer: Lumi United Technology Co., Ltd.

Address: 8th Floor, JinQi Wisdom Valley, No.1 Tangling Road, Liuxian Ave, Taoyuan Residential District, Nanshan District, Shenzhen, China.